

Team:

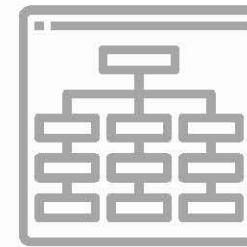

Information Architecture of Routine Maker

Concepting

Selected Themes

Information Architecture of Routine Maker

- Google Assistant should have the option to **add an action** to a routine directly from YouTube music.
- For a lot of users, the context to use **"Time delay"** is not **clear**.
- Many customization functions are **hidden** and **hard to access** for users.
- A vertical list of 14 items is hard to scan and **overwhelming** to process.

Team:



Concepting

Selected Themes

Information Architecture of
Routine Maker

We Believe/We Know

We Believe

We believe that **simplifying the information architecture** and strengthening the naming system of the routine functions in the Google Home app will provide users with **better control settings** and **easier navigation** while building habits with Google Assistant.

We Know

We know that this is true because Google Assistant would be **more accessible** to users.

Team:



Concepting

Selected Themes

Information Architecture of Routine Maker

Information Architecture

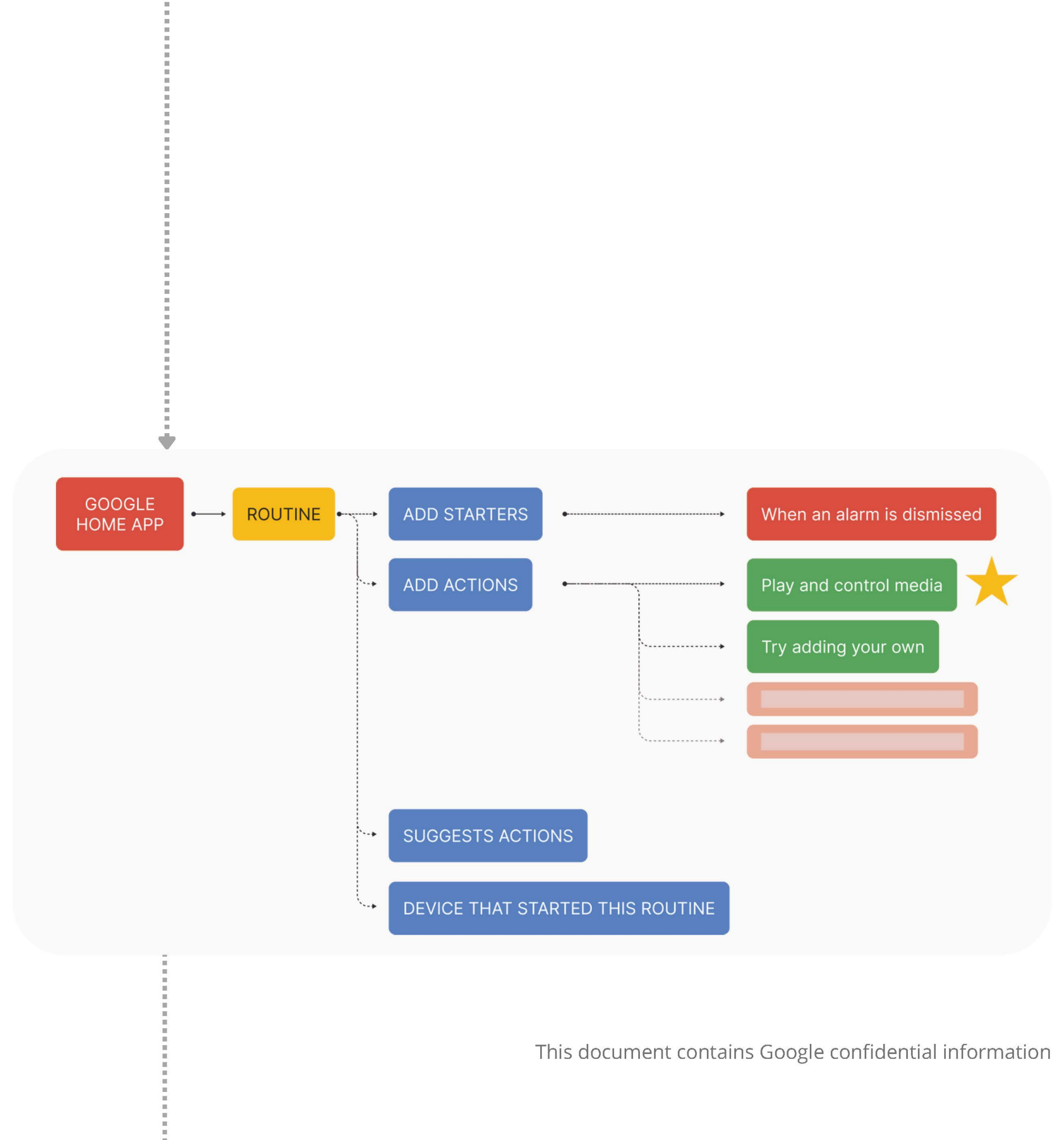

Team:



Concepting

Selected Themes

Information Architecture of
Routine Maker

Wireframes

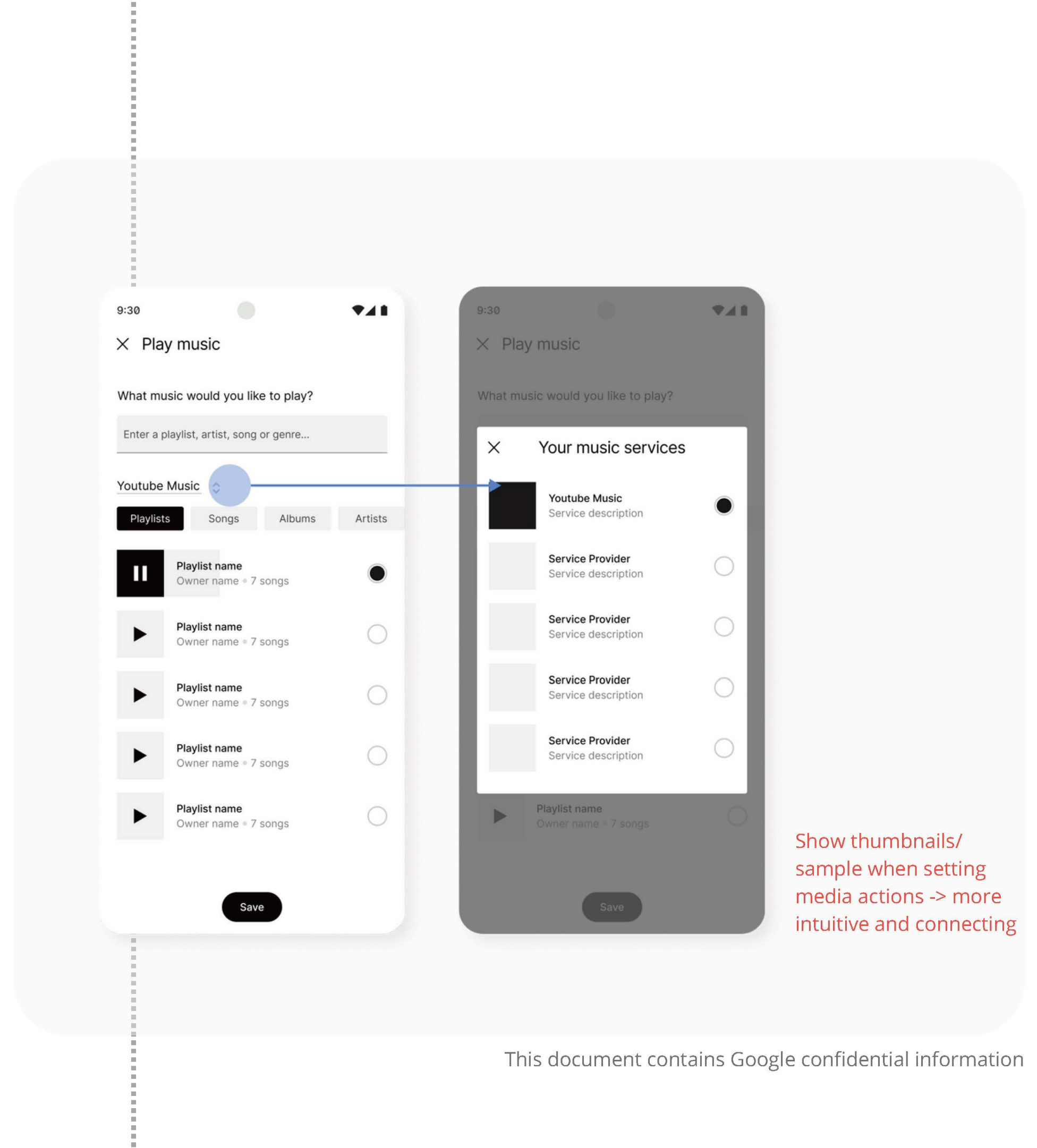

Team:



Concepting

Selected Themes

Information Architecture of
Routine Maker

Wireframes

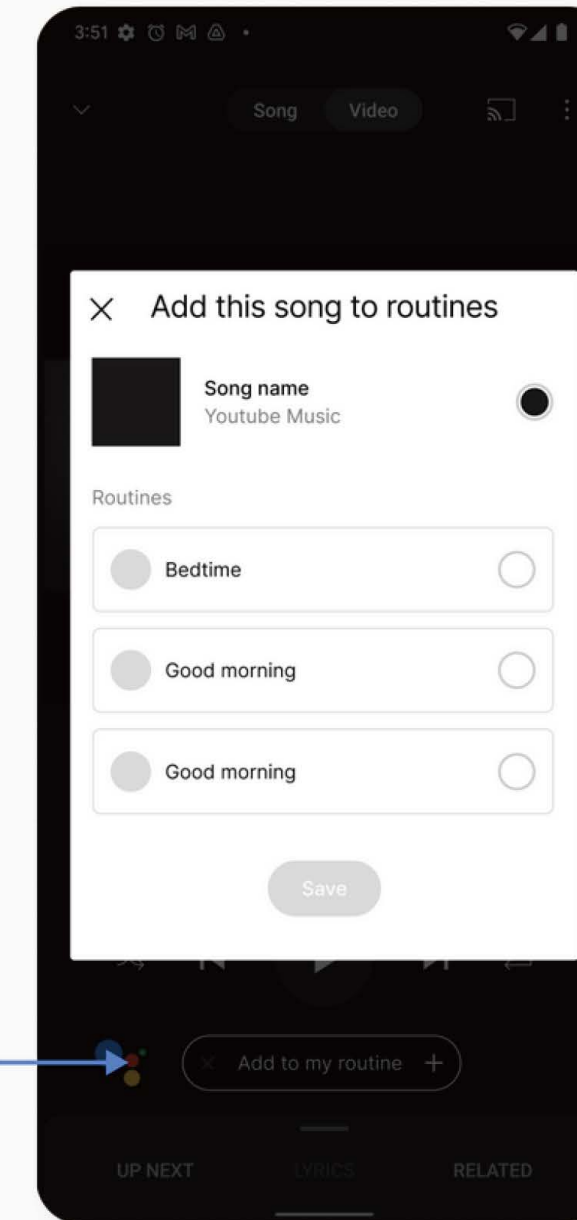
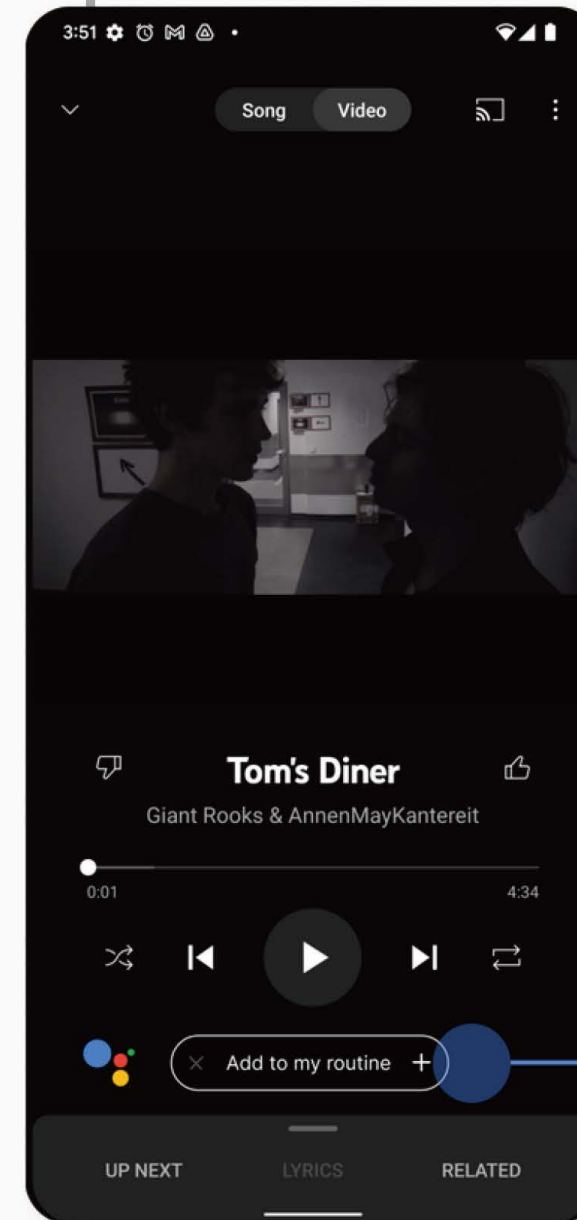

Add a song from
YouTube music to a
routine